

TEAM LOSI SETUP SHEET EIGHT

Name: David Lim Date: 20-01-2008 Event: Ho Bao Cup (M'SIA)
 City: K.L State: _____ Track: HPC - Glenmarie
 Track Indoor Tight Smooth Hard Packed Blue Groove Wet Low Bite High Bite
 Conditions Outdoor Open Rough Loose/Loamy Dry Dusty Med Bite Other _____

Front Suspension
 Toe: 1 degree toe-out
 Ride Height: _____
 Camber: -1.5 degrees
 Caster: stock (20 degrees)
 Sway Bar: 2.3 mm (Black)
 Piston/Oil: S4 / 40wt Team Losi
 Spring: Silver
 Limiter/Droop: 94 mm
 Overall Shock Length: _____
 Steering Ackerman: Long
 Bump Steer: Down
 Camber Link: #3
 Shock Location: #2 / inside
 Front Diff Fluid: 5000 Team Losi
 Receiver Battery Type: LRP 1400 mah
 Center Diff Fluid: 7000 Team Losi

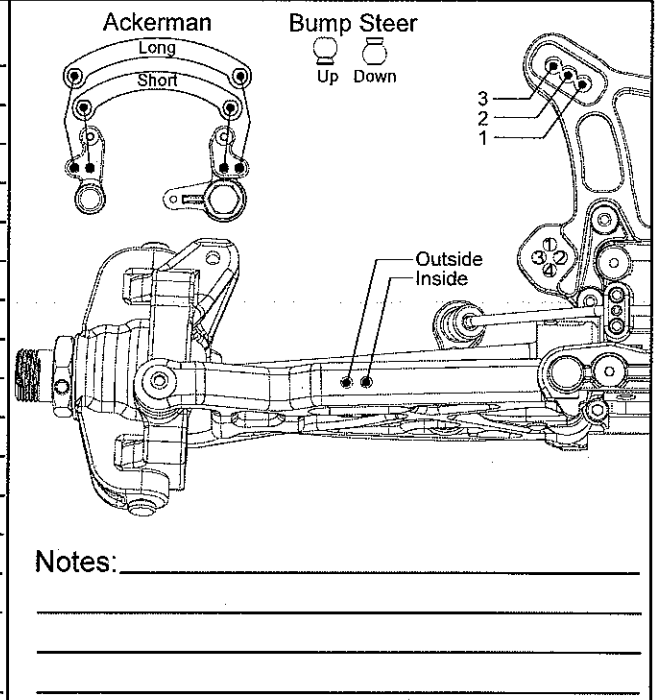

Rear Suspension
 Toe: 3 degrees
 Anti-Squat: 2 degrees
 Ride Height: All the way back
 Camber: -3 degrees
 Rear Hub Spacing: All the way back
 Sway Bar: 2.3 mm (Black)
 Piston/Oil: S6 / 30 wt Team Losi
 Spring: Green
 Limiter/Droop: 105 mm
 Overall Shock Length: _____
 Camber Link: #4/c
 Shock Location: #3 / inside
 Rear Diff Fluid: 2000 Team Losi

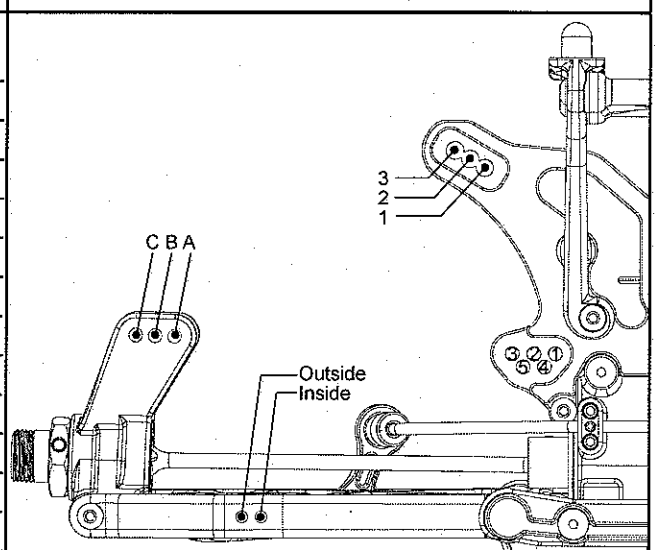

Engine
 Engine: Werks B7 Pro Fuel: Werks 30%
 Glow Plug: O'Donnell 99T Head Clearance: _____
 Pipe/Header: Werks 2013 Gearing: 13/48

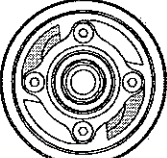
Clutch Clutch Shoes and Springs Info

4 Aluminum - silver springs

Tires	Type	Compound	Insert
Front:	<u>Proline C-Fighter</u>	<u>M3 (soft)</u>	<u>Foam</u>
Rear:	<u>Proline C-Fighter</u>	<u>M3 (soft)</u>	<u>Foam</u>
Notes:	_____		