

NAME **Gabriele Vignolini**
 COUNTRY **Italy**
 RACE **ETS Round 2**
 TRACK **Scandiano**

SETUP SHEET

DATE **22/01/2012** TEMP.°C AIR / TRACK /
 TRACK CONDITION TECHNICAL MIXED FAST
 TRACTION LOW MEDIUM HIGH

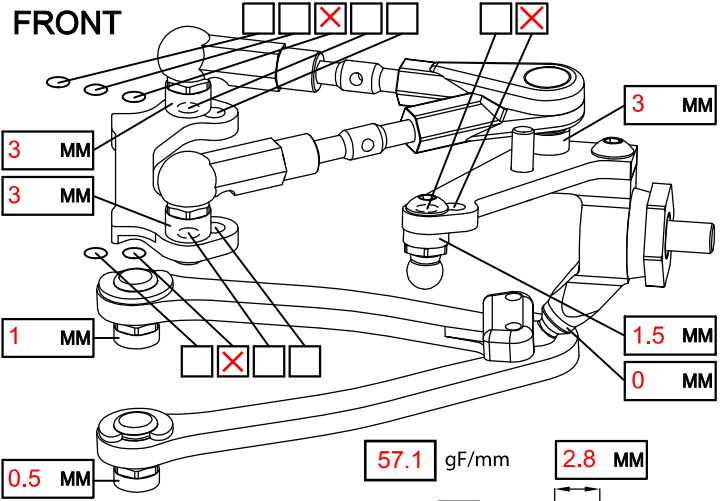

CAMBER ANGLE / ° **-1.5**
 CASTER ANGLE / ° **5**
 TOE ANGLE / ° **1**
 RIDE HEIGHT / MM **5.2**
 DOWNSTOP / MM **4.5**
 UPSTOP / MM **max**
 STABILIZER Ø / MM **1.3**
 LOW ARM STD
 STEERING ARM STD
 WHEEL SPACER / MM **0.5**

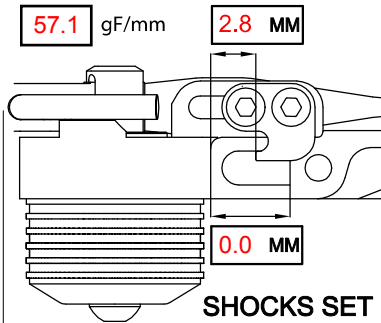

SHOCKS SET

SPRING STD
 DAMPER STD
 ACTION SYM. ASYM.
 SRS/RHS ARR. I II

FRONT DRIVE BALL DIFF GEAR DIFF SPOOL ONE-WAY
 DIFF SET LOOSE MEDIUM TIGHT OIL #
 DOGBONE DRIVE BUSHING C-DRIVE BB EVD

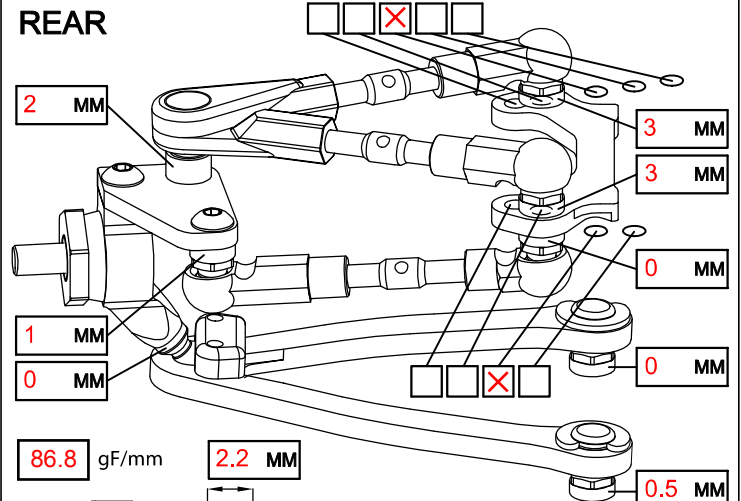

CAMBER ANGLE / ° **-2**
 CASTER ANGLE / ° **4 mm diff.**
 TOE ANGLE / ° **-3**
 RIDE HEIGHT / MM **5.3**
 DOWNSTOP / MM **4**
 UPSTOP / MM **max**
 STABILIZER Ø / MM **1.0**
 LOW ARM STD
 STEERING ARM STD
 WHEEL SPACER / MM

SPRING STD
 DAMPER STD
 ACTION SYM. ASYM.
 SRS/RHS ARR. I II

REAR DRIVE BALL DIFF GEAR DIFF
 DIFF SET LOOSE MEDIUM TIGHT OIL # **100wt**
 DOGBONE DRIVE BUSHING C-DRIVE BB EVD

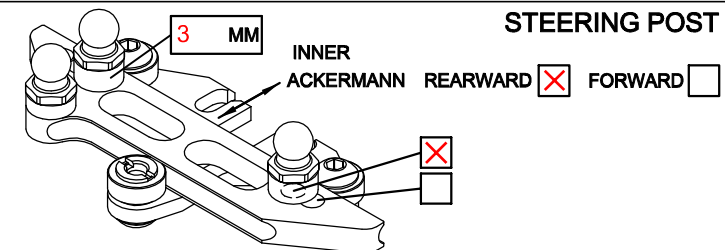
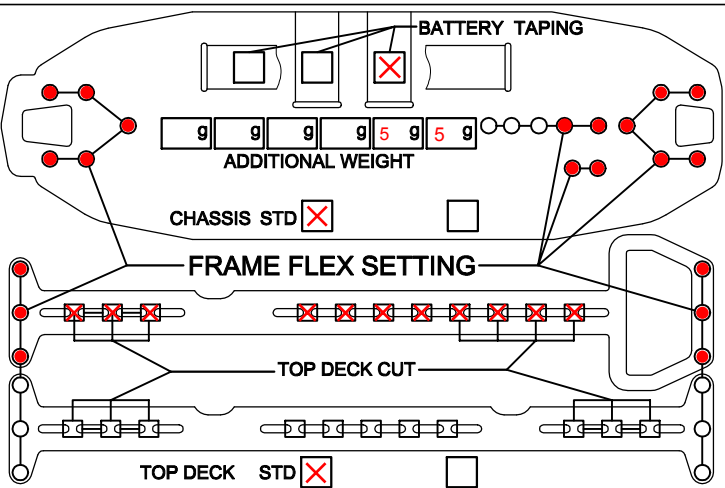

FL	FR	RL	RR	TIRES	FRONT	REAR
				BRAND	Ride 32	Ride 32
				INSERTS		
				WHEELS		
				ADDITIVE		

MOTOR LAYOUT LONG. TRANS. MOTOR **Sp 13.5 V3**
 SERVO LAYOUT LEFT RIGHT SERVO
 ESC LAYOUT LEFT RIGHT ESC **Cirtix**
 BAT. LAYOUT R1 R2 F1 F2 BATTERY
 SPUR **87** PINION **41** RECEIVER
 FINAL DRIVE RATIO **4.52** MOTOR OFFSET / MM
 BODY **Mazda 6 Speed** WING

BEST LAPTIME QUALIF. / FINAL POSITION /
 ESC SETTING
 COMMENTS / IMPRESSIONS
 CONTACT