

Name: Josh Hohnstein  
 Event: \_\_\_\_\_  
 Conditions: medium bite carpet

Date: \_\_\_\_\_  
 Track: Trackside

For Team Driver's setups, please visit [www.RC10.com](http://www.RC10.com) or [www.TeamAssociated.com](http://www.TeamAssociated.com)!

Reset Fields

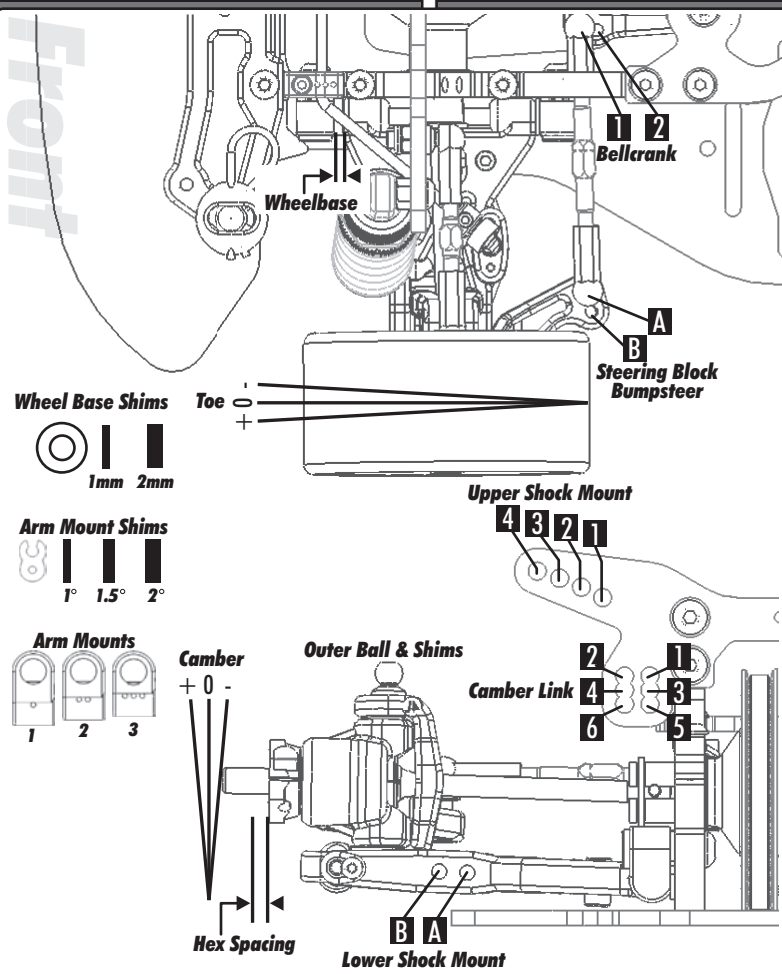

Front	Alignment	Rear
5.25	Ride Height	5.5
1.75	Camber	2
4	Caster	N/A
N/A	Rear Hub Toe	0
0	Toe (Total)	3
+1mm	Hex Spacing	+1mm
2mm	Wheelbase	2mm
2-b	Steering Link	N/A
silver+1mm	Bumpsteer	N/A

Notes:

Suspension Geometry		
2-a	Shock Position	1-b
1	Camber Link Position	2-b
silver	Outer Ball & Shims	silver +2mm
2-b	FWD Arm Mount	2-b
1.6mm	FWD Mount Shims	.8mm
2-b	RWD Arm Mount	3-b
1.6mm	RWD Mount Shims	3.4mm
2mm over	Droop	2mm over
none	Anti-Roll Bar	black

Notes:

Shocks		
45	Oil	45
57	Piston	57
100%	Rebound	100%
blue	Spring	silver

Notes: full foam in bladder

Differentials		
oneway	Type	diff
	Setting	med-loose
a	Cam Holder	a
2	Belt Tension Number	14

Notes:

Tires		
jaco blue	Tire	jaco blue
	Tire Diameter	
	Insert & Wheel	
jack-full	Additive & Amount	jack-full

Notes:

Chassis		
Chassis: itf		
Top Plate: itf		
Notes: no o-rings		

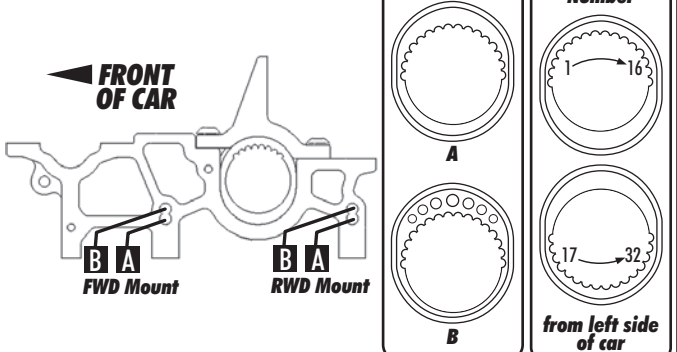
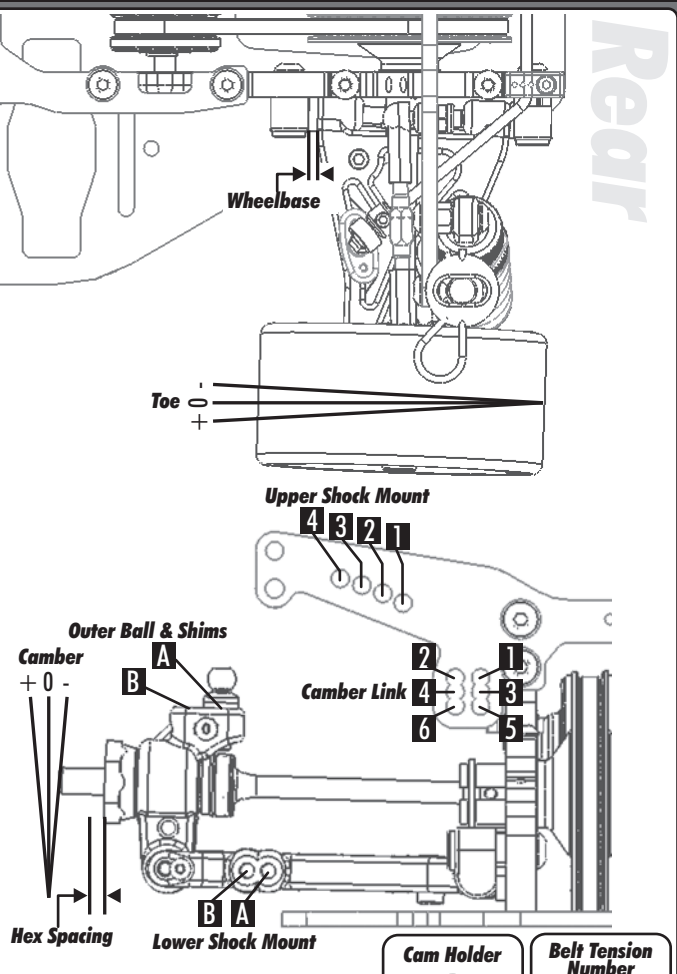

Transmitter	
Turning Circle:	4 ft
Steering Expo:	
Brake E.P. :	
Throttle Expo:	
Speed Control	
S.C. Type:	1rp
S.C. Settings:	1-8-2-2

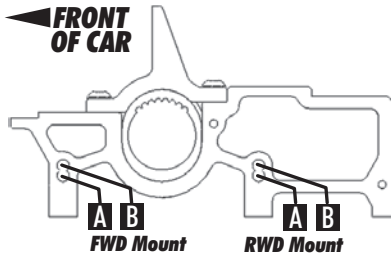

Motor	Gear	Notes
Trinity duo 13.5	100 / 41	timing in middle hole

Body & Wing
speed 6 LW

Battery
Trinity ip 3800 35c