

Front	Alignment	Rear
6	Ride Height	6
-1.5	Camber	-2.0
4	Caster	N/A
N/A	Rear Hub Toe	0
0	Toe (Total)	3
+1 mm	Hex Spacing	+1 mm
1 mm	Wheelbase	2 mm
2-B	Steering Link	N/A
2 mm	Bumpsteer	N/A

Notes:

Suspension Geometry		
2-A	Shock Position	1-B
3	Camber Link Position	3-B
0 - Black	Outer Ball & Shims	2 mm - Black
3-B	FWD Arm Mount	2-B
1.5 mm	FWD Mount Shims	1.0 mm
3-B	RWD Arm Mount	3-B
1.5 mm	RWD Mount Shims	3.7 mm
1 mm	Droop	1 mm
None	Anti-Roll Bar	1.2 mm

Notes: Droop measured above ride height

Shocks		
50	Oil	50
3	Piston	3
50%	Rebound	50%
Blue	Spring	Silver

Notes:

Differentials		
Aluminum	Type	Aluminum
Spool	Setting	Standard
B	Cam Holder	B
13	Belt Tension Number	16

Notes:

Tires		
Sorex	Tire	Sorex
	Tire Diameter	
	Insert & Wheel	
LRP Top2	Additive & Amount	LRP Top2

Notes:

Chassis		
Chassis: ITF Chassis		
Top Plate: ITF Chassis		
Notes: No screw in motor mount		

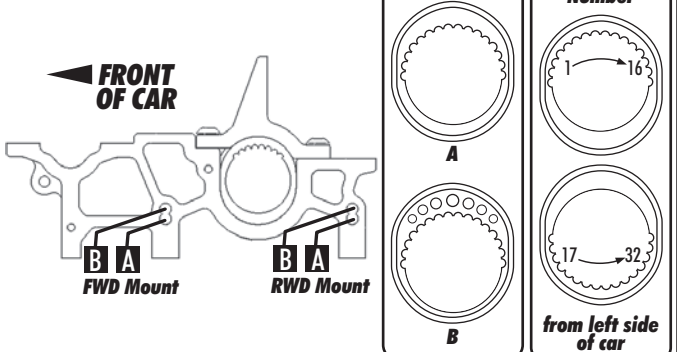
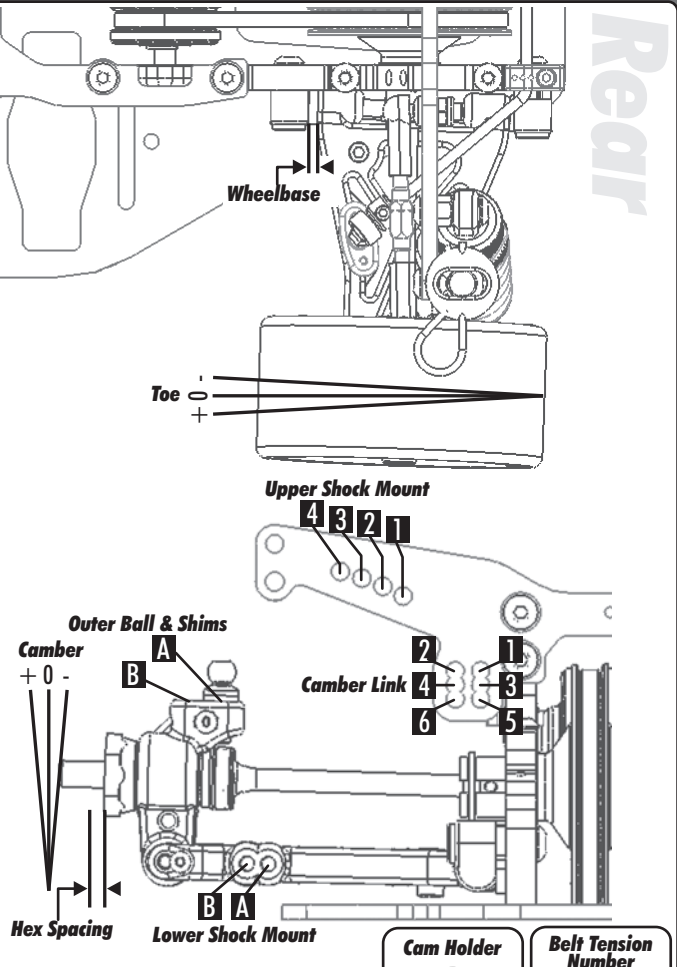

Transmitter	
Turning Circle:	
Steering Expo:	
Brake E.P. :	
Throttle Expo:	
Speed Control	
S.C. Type:	LRP TC Spec
S.C. Settings:	2/3/1/3

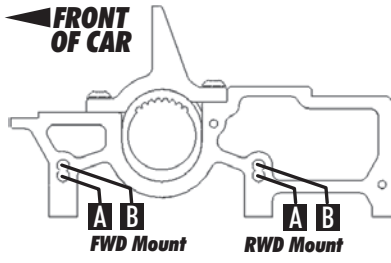

Motor	Gear	Notes
LRP 3.5	87 / 18	12.5mm Rotor

Body & Wing
Protoform Mazda 6 Lightweight

Battery
Reedy IB 4600