

Driver: Teemu Leino
Date: 12/16 - 12/18 2005
Meeting: GP Carpet Wars
Best Time:

Schumacher



FRONT SETTINGS

Ride Height 5 mm
 Anti-Roll Bar..... No
 Castor..... 2° 4° 6°
 Kick Up..... mm Anti-Dive..... mm
 Toe-In/Out..... Out 5 degrees
 Roll Centre 3mm mm
 Camber..... 1.5 degrees
 Wishbone Short Mid/Short Mid/Long Long

Notes: Roll-center: Riser plate plus 1mm. 20% negative steering expo.

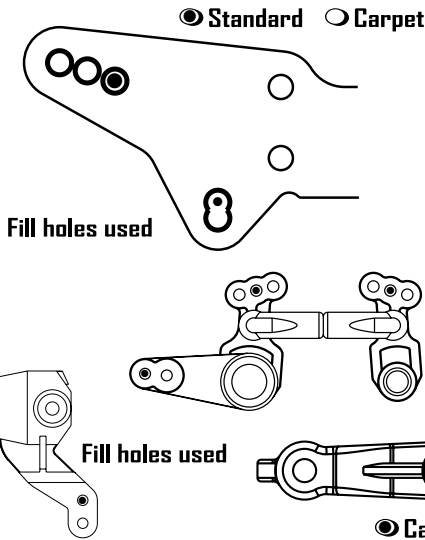

FRONT SHOCKS

Oil..... 55wt
 Spring..... Tamiya White
 Piston..... 2 ✓ 3
 Length..... 60.8 mm
 Droop..... mm

Centre Track Rod Length 40.8 mm

REAR SETTINGS

Ride Height 5.3 mm
 Anti-Roll Bar..... No
 Anti/Pro Squat.....
 Toe-In (In)..... 3 degrees
 Roll Centre 2.5 mm
 Camber..... 2 degrees
 Wishbone Short Mid/Short Mid/Long Long

Notes: Roll center: Stock Riser plate, no spacers.

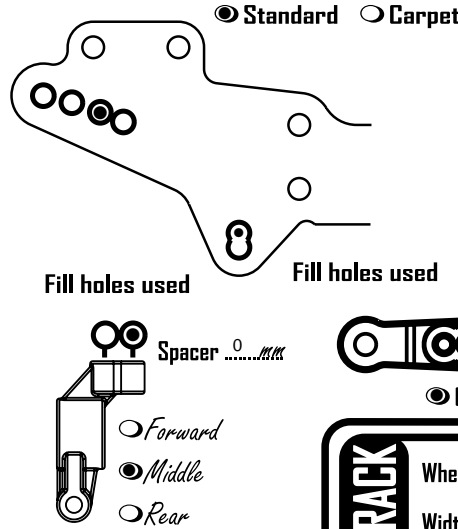

REAR SHOCKS

Oil..... 45wt
 Spring..... AE Silver
 Piston..... 2 ✓ 3
 Length..... 61 mm
 Droop..... mm

TRACK WheelBase 258 mm
 Width Front..... 187 mm Rear..... 188 mm

OTHER SETTINGS

Bodyshell Mazda
 Differential Standard Locked One-Way
 Chassis Stock
 Top Deck Stock
 E.S.C. Hara Twister
 Cells GP3700
 Servo
 Receiver

MOTOR & GEARING

Motor 12x1
 Brush
 Spring
 Timing degrees
 Pinion Size tooth
 Spur Size tooth

TRACK CONDITIONS

VENUE Indoor Outdoor
SURFACE Carpet Concrete Tarmac
TYPE Tight Open
GRIP High Medium Low
CONDITION Smooth Bumpy

TYRES & WHEELS

Front Tyres CS27
 Rear Tyres CS27
 Front Inserts JB Blue
 Rear Inserts JB Blue
 Wheel Orion
 Tyre Additive Yes No Type Orion

DRIVERS NOTES