

Driver: Paul Wynn
Date:
Meeting: State Race #1
Best Time: 13.8



FRONT SETTINGS

Ride Height 5 mm
 Anti-Roll Bar Stock (silver)
 Castor 2° 4° 6°
 Kick Up mm Anti-Dive mm
 Toe-In/Out Out 5 degrees
 Roll Centre (Stock) 3 mm
 Camber 2 degrees
 Wishbone Short Mid/Short Mid/Long Long

Notes: Droop measured on blocks.

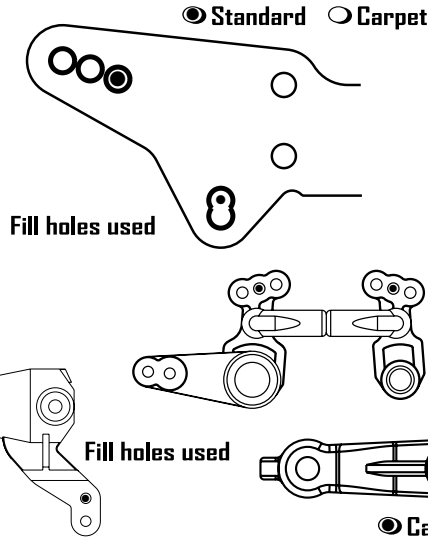

FRONT SHOCKS

Oil 25wt
 Spring White
 Piston 2 3 ✓
 Length 60.9 mm
 Droop 5 mm

Centre Track
 Rod Length 40.8 mm

REAR SETTINGS

Ride Height 5 mm
 Anti-Roll Bar Stock (silver)
 Anti/Pro Squat
 Toe-In (In) Stock degrees
 Roll Centre Stock mm
 Camber 1.5 degrees
 Wishbone Short Mid/Short Mid/Long Long

Notes: Droop measured on blocks.

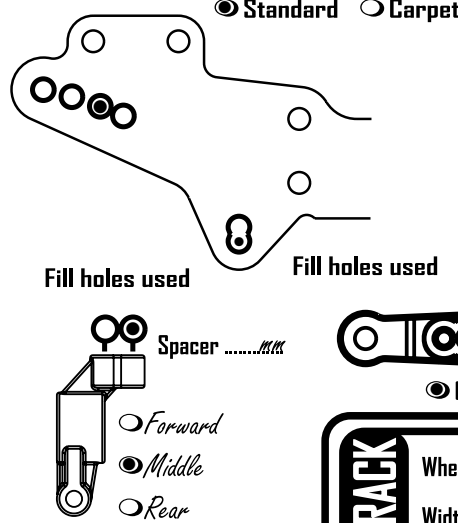

REAR SHOCKS

Oil 30wt
 Spring White
 Piston 2 3 ✓
 Length 62 mm
 Droop 4 mm

TRACK WheelBase mm
 Width Front 185 mm Rear 185 mm

OTHER SETTINGS

Bodyshell Protoform Mazda
 Differential Standard Locked One-Way
 Chassis Stock 2mm
 Top Deck Stock 2mm
 E.S.C. LRP
 Cells Fusion 3800
 Servo Airtronics
 Receiver LRP

MOTOR & GEARING

Motor Reedy Ti 8x2
 Brush Reedy 777
 Spring Black
 Timing 22 degrees
 Pinion Size 18 tooth
 Spur Size 89 tooth

TRACK CONDITIONS

VENUE Indoor Outdoor

SURFACE Carpet Concrete Tarmac

TYPE Tight Open

GRIP High Medium Low

CONDITION Smooth Bumpy

TYRES & WHEELS

Front Tyres CS27GLR
 Rear Tyres CS27GLR
 Front Inserts
 Rear Inserts
 Wheel
 Tyre Additive Yes No Type Tweak

DRIVERS NOTES

Car was very easy to drive with great cornerspeed.