

Name: Cloaked Date: 17/11/12 Event: N/A

City: Sydney Australia State: NSW Track: Sydney RC

Track Conditions: Indoor Tight Smooth Hard Packed Blue Groove Wet Grass Low Bite High Bite
 Outdoor Open Rough Loose/Loamy Dry Dusty Astro Turf Med Bite Other _____

Front Suspension

Toe: 0
 Ride Height: 20
 Camber: -1
 Caster: 0° 3° 5° 10°
 Kick Angle: 20° 25° 30°
 Sway Bar: N/A
 Oil: 30wt
 Piston: 55
 Spring: Red
 Spindle Type: Inline Trailing
 Shock Limiters: 2mm
 Shock Location: 2/Outside
 Bump Steer: 2mm
 Camber Link: 2

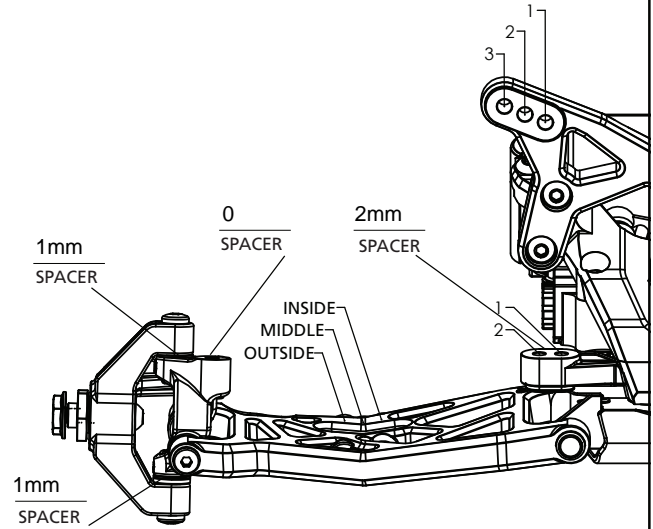

Notes: 25* Brass Kick Shim, 10grams Weight on top of Servo.

Rear Suspension

Chassis Configuration: Rear Motor Mid Motor
 Toe: 3
 Anti-Squat: 2.5
 Roll Center: Low Roll Center (LRC) High Roll Center (HRC)
 Ride Height: 20
 Camber: -1
 Rear Hub Spacing: Middle
 Hex Width: Stock
 Sway Bar: N/A
 Oil: 27.5wt
 Piston: 55
 Spring: White
 Shock Limiters: 2mm
 Camber Link: 2/B
 Shock Locations: 1/Outside
 Wing/Wickerbill: Wing Forward
 Battery Position: Full 5300 Pack Pushed Back

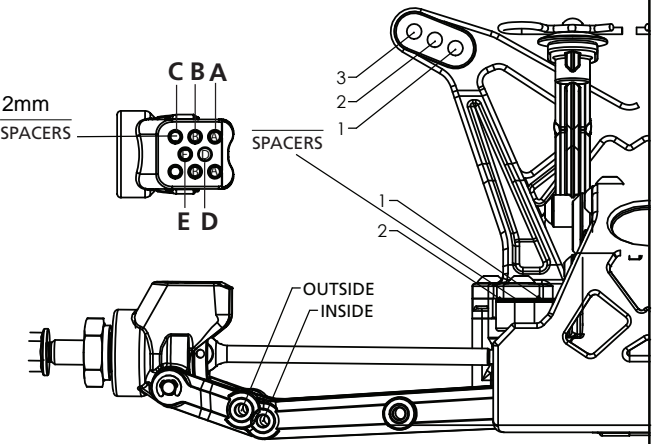

Electronics

Radio: DX3C
 Servo: BMS 621MG
 ESC: HW JS 45amp
 Initial Brake: 20%
 Drag Brake: 30%
 Throttle Profile: 2
 Timing Advance: Max On motor
 Throttle/Brake Expo: 0/20%
 Servo Expo: 5%
 Throttle/Brake EPA: N/A
 Motor: Orion 17.5
 Pinion: 34 Spur: 70
 Battery: Gens Ace 5300 30c

Weight Placement (Mark with "X")	Tires	Compound	Insert	Additive
<p>Weight of each piece _____ oz./g</p>	Front: <u>AKA Rebar</u>	<u>Soft</u>	<u>Soft</u>	_____
	Rear: <u>AKA Rebar</u>	<u>Soft</u>	<u>Soft</u>	_____
Notes: <u>1mm Raised Tranny Mod.</u>				